

# 11 Track lights and tracks

## WAVE2

### Quickinfo

#### LUMINAIRE

ceiling, wall  
installation in 3P-track  
aluminum, white/black  
IP20



#### LED

3000K, 4000K  
CRI>90  
initial MacAdam 3 SDCM  
50.000h L80

#### OPTIC

symmetric 24°/38°/60°  
exchangeable reflector

#### ELECTRIC

PHASE dim  
DALI dim

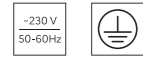

### Description

LED track spotlights made of die-cast aluminum in 2 different sizes. Minimalistic design with clear lines. High flexibility with a 350° rotatable and 90° adjustable spotlight head. Brilliant object staging with a faceted high-gloss reflector and state-of-the-art LED technology. Tool-free replaceable reflector unit for precise and individual adjustment of the beam characteristics on-site. No formation of multiple shadows and high color rendering index (CRI>90).



10W



30W



40W

### Types

PRODUCT CODE	POWER	LUMINOUS FLUX	COLOUR TEMP.	WEIGHT
SLW2S10.XXX3X	10W	900lm	3000K 4000K	0,7kg
SLW2M30.XXX3X	30W	2.700lm		1,5kg
SLW2M40.XXX3X	40W	3.400lm		2,0kg

.X|X|X|X|X  
1 2 3 5

1 Control  
2... DALI dim  
5... PHASE dim

2 Optic  
1... WIDE 60°  
2... MEDIUM 38°  
3... SPOT 24°

3 Colour Temp.  
3... 3000K  
4... 4000K

5 Housing colour  
2... white  
3... black

### Optic

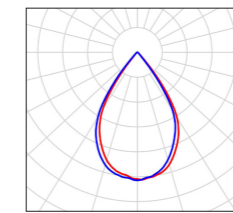

WIDE 60°

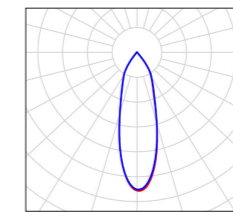

MEDIUM 38°

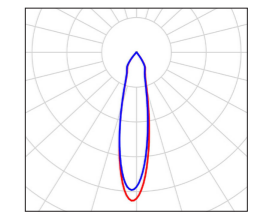

SPOT 24°

### Dimension

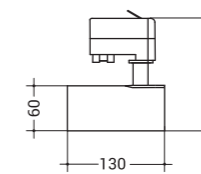

10W

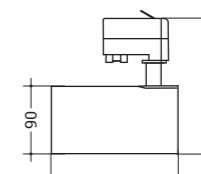

30W

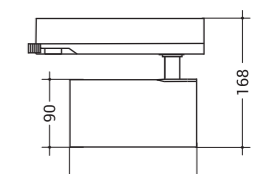

40W



### Accessories

	PRODUCT CODE	DESCRIPTION
	SLW2SZB010.X	FLEX glare protection for WAVE2 - 10W
	SLW2MZB010.X	FLEX glare protection for WAVE2 - 30W/40W
	SLW2SZB020.X	COMB glare protection for WAVE2 - 10W
	SLW2MZB020.X	COMB glare protection for WAVE2 - 30W/40W

X Housing colour  
2... white  
3... black

